

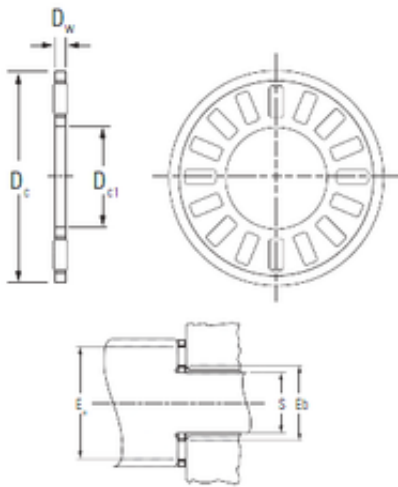

# BEARING CORP.OF AMERICA

## KOYO NTA-411 needle roller bearings



Bearing No. NTA-411

Size	6.35x17.45x1.984 mm
Bore Diameter	6,35 mm
Outer Diameter	17,45 mm
Width	1,984 mm
d	6,35 mm
D	17,45 mm
T	1,984 mm
Ea	14,732 mm
Eb	8,636 mm
Weight	0,001 Kg
Basic dynamic load rating (C)	5,12 kN
Basic static load rating (C0)	10,76 kN
Category	Thrust Roller Bearing
Inventory	519.0
Manufacturer Name	KOYO
Minimum Buy Quantity	N/A
Weight / Kilogram	0.002
Product Group	B04144
Rolling Element	Needle Roller Bearing
Self Aligning	No
Component Description	Roller Assembly Only
Thrust Bearing	Yes
Single or Double Direction	Single Direction
Banded	No
Cage Material	Steel
Precision Class	ABEC 1   ISO P0

NTA-411 Bearing 2D drawings and 3D CAD models



## BEARING CORP.OF AMERICA

Other Features	Single Row   Two Piece Cage
Long Description	1/4" Bore 1; 1/4" Bore 2; 11/16" Outside Diameter; 5/64" Height; Needle Roller Bearing; Single Direction; Not Self Aligning; Not Banded; Steel Cage; ABEC 1   ISO P0; Roller Assembl
Inch - Metric	Inch
Category	Thrust Roller Bearings
UNSPSC	31171500
Harmonized Tariff Code	8482.99.25.40
Noun	Roller Assembly
Keyword String	Thrust Needle
Manufacturer URL	<a href="http://www.koyousa.com">http://www.koyousa.com</a>
Manufacturer Item Number	NTA-411
Weight / LBS	0.003
Bore 1	0.25 Inch   6.35 Millimeter
Bore 2	0.25 Inch   6.35 Millimeter
Overall Height with Aligning Washer	0 Inch   0 Millimeter
Outside Diameter	0.688 Inch   17.475 Millimeter
Height	0.078 Inch   1.981 Millimeter
Bearing No.	NTA-411
Dc1	6.35
Dc	17.45
Dw	1.984
Ca	5.12
C0a	10.76
Cu	1.05
Limiting speeds(min-1)	26000
(Refer.)Mass(kg)	0.001



## BEARING CORP.OF AMERICA

Washer designation	TRA-411
d1	17.45
h(max)	0.81
h(min)	0.76
S(max)	6.35
S(min)	6.27
H	18.26
(Refer.)Washer mass(kg)	0.001